

**Fire Station Renovation and  
Police Station Addition**  
Building 7200 - Camp Joseph T. Robinson  
North Little Rock, Arkansas

REVISIONS

ISSUE DATE  
JULY 1, 2016  
PROJECT NO.  
0901U

CONTENTS  
REFLECTED CEILING  
PLAN

SHEET NUMBER

**A2.2**

ALLOW FOR THE PATCHING OF FIVE HOLES IN THE EXISTING CONCRETE 'T' STRUCTURE

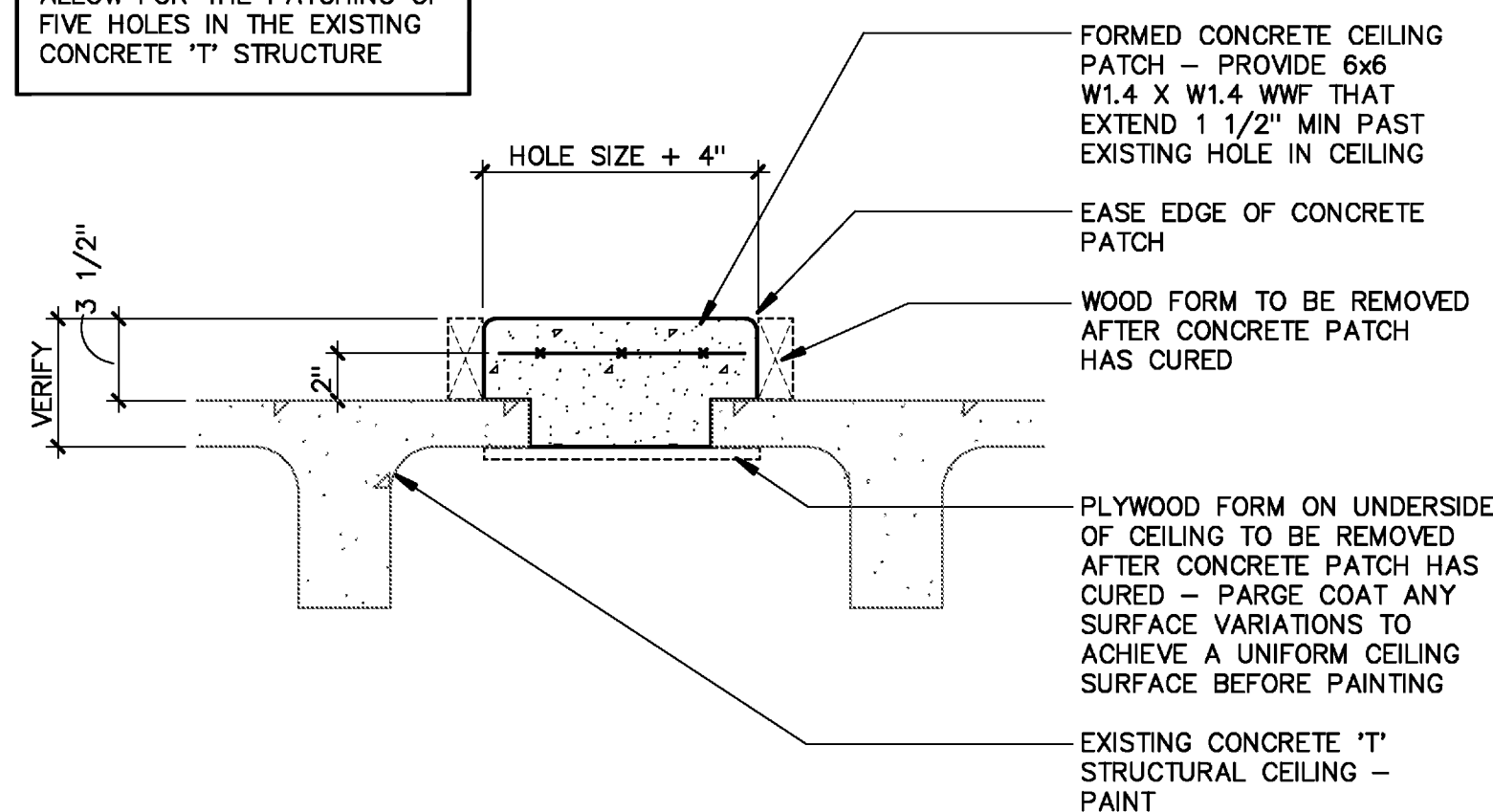

**2 CEILING PATCH DETAIL**  
1 1/2" = 1'-0"

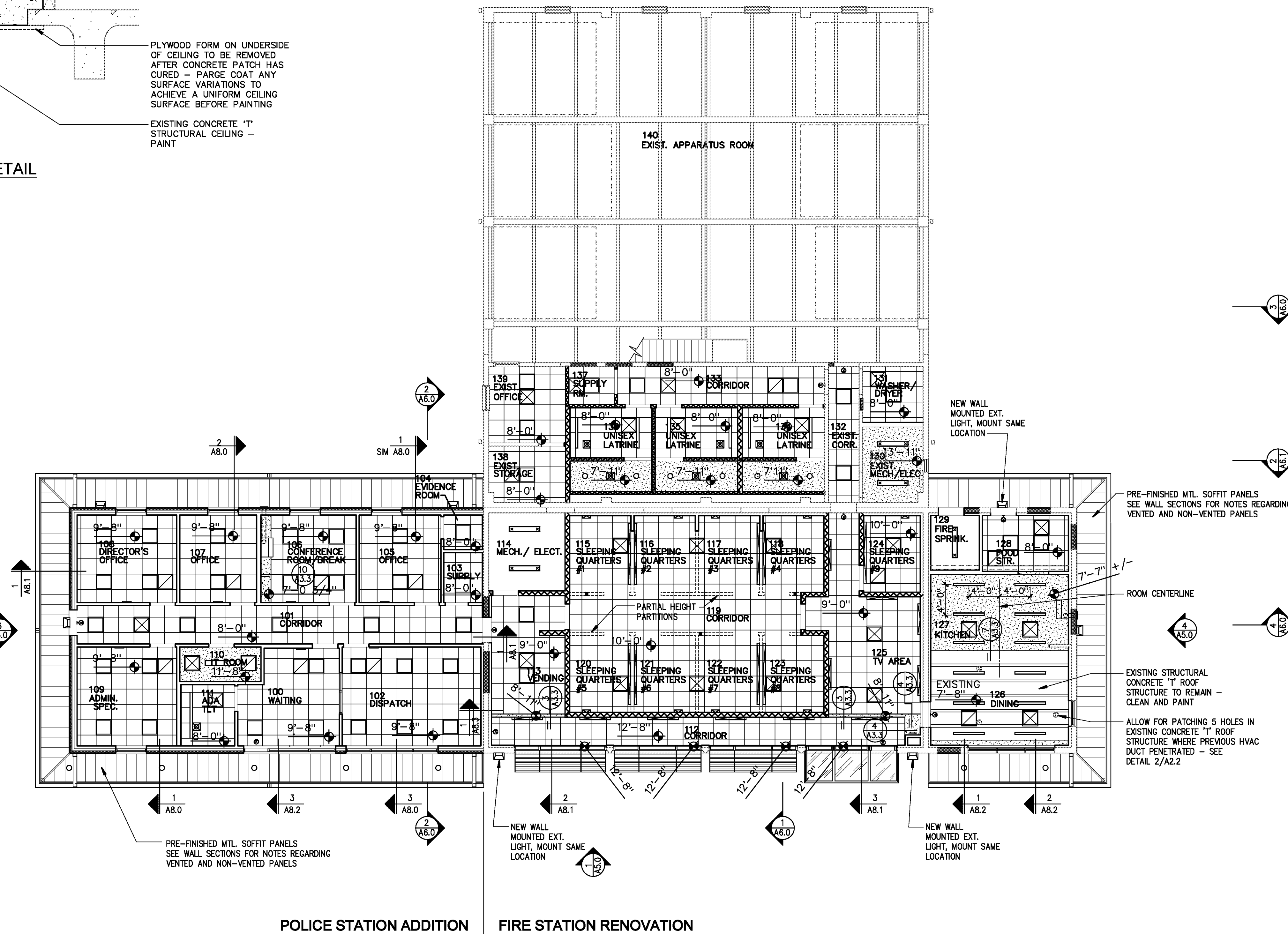
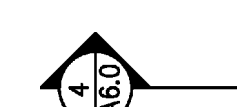
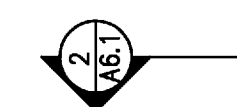
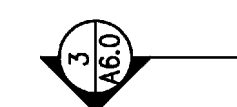

**1 REFLECTED CEILING PLAN**  
1/8" = 1'-0"

LEGEND

10'-0"	CEILING HT. ABOVE FIN. FLOOR		2 X 4 LED LIGHT FIXTURE		STRIP LED LIGHT FIXTURE		SURFACE MOUNTED LED LIGHT FIXTURE		RECESS MOUNTED WALL LIGHT (MOUNT VERTICAL, SEE INTERIOR ELEVATIONS)
	EXHAUST FAN		2 X 2 LED LIGHT FIXTURE		EXIT SIGN (WALL MOUNT)		WALL MOUNTED LED READING LAMP		EXTERIOR WALL MOUNTED LED LIGHT FIXTURE
	RETURN AIR GRILLE		RECESSED FIXTURE		EXIT SIGN (CEILING MOUNT)		CHAIN SUSPENDED STRIP LED LIGHT FIXTURE		
	SUPPLY AIR GRILLE		STRIP LED LIGHT FIXTURE WALL MOUNT		PENDANT TYPE STRIP LED LIGHT FIXTURE (100% DOWN LIGHT)				
	EXHAUST FAN WITH LIGHT								

NOTE: SEE INTERIOR ELEVATIONS FOR THE LOCATIONS OF WALL MOUNTED FIXTURES, UNDERCABINET LIGHTS AND SUSPENDED FIXTURES IN THE KITCHEN / DINING AREA.